



**mm MLI**

**Features**

- 2,5/5/10/12,5/20 /251µm resolution (other options on request)
- Magnetic contactless measurement
- Push-pull, TTL Linedriver or HTL Linedriver output options
- Single or Continues reference (optional)
- Weak magnetic field and power on LEOs



**Technical Specifications**

|                        |  |
|------------------------|--|
| Type of measurement    | Magnetic incremental non-contact                   |
| Resolution             | 2,5/5/10/12,5/20 /25 1µm resolution (4x mode)      |
| Accuracy               | ± 15µm   |
| Output type            | Push-Pull, TTL Linedriver, HTL Linedriver          |
| Supply voltage         | 8-24VDC (Standard), 5VDC (Optional)                |
| Electrical connections | 2,5m cable (Standard), 1m cable with 089 connector |

|                       |  |
|-----------------------|--|
| Case material         | Anodized aluminium   |
| Max. Speed            | 3 m/s with LED indicator<br>15 m/s without LED indicator as optional |
| IP degree             | IP 66  |
| Operating temperature | -20°C ... +80°C  |
| Storage temperature   | -30°C ... +90°C  |

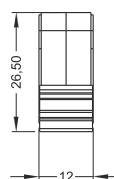
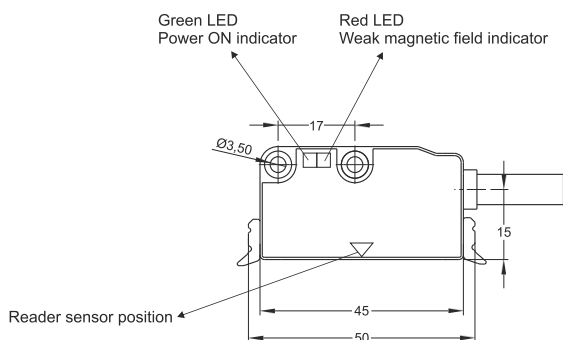

**Linedriver Cable Output**

- Ch A : Black
- Ch A inv. : Yellow
- Ch B : White
- Ch B inv. : Green
- +V : Brown
- 0V : Blue
- GND : Shield

**Push-Pull Cable Output**

- Ch A : Black
- Ch B : White
- +V : Brown
- 0V : Blue
- GND : Shield

| Model         | Resolution   | Output type   | Pole pitch         | Output channels                                | Supply voltage              | Connector / Cable   |
|---------------|--|---|--------------------|--|-----------------------------|---|
| (example) MLI | T20  | LTP   | 5                  | B  | V2                          | 1M  |
| MLI           | T10 : 2,5 µm<br>T20 : 5 µm<br>T40 : 10 µm<br>T50 : 12,5 µm<br>T80 : 20 µm<br>T100: 25 µm | LTP : Push-pull<br>TT : TTL Linedriver<br>HLD : High Linedriver | 5 : 5mm pole pitch | B : A, B<br>5Z : A, B, Z (Continues reference) | V1 : 5V DC<br>V2 : 8-24V DC | 1M : 1 meter cable (standard)<br>2M5 : 2,5 meter cable<br>9C : 0,5 meter cable with 9 pin connector |

07.2019 | version 0001

The information provided herein is to the best of our knowledge true and accurate, it is provided for guidance only. All specifications are subject to change without prior notification.

**Althen – Your expert partner in Sensors & Controls | [althensensors.com](http://althensensors.com)**

Althen stands for pioneering measurement and custom sensor solutions. In addition we offer services such as calibration, design & engineering, training and renting of measurement equipment.

Germany / Austria / Switzerland  
info@althen.de

Benelux  
sales@althen.nl

France  
info@althensensors.fr

Sweden  
info@althensensors.se

USA / Canada  
info@althensensors.com

Other countries  
info@althensensors.com