



N TBT Shackle Loadcell

Description

- Capacity from 30000 kg to 250000 kg
- 17-4 ph stainless steel
- Holes for standard shackles
- Combined error = $\pm 0.08\%$
- Protection class ip68



Manufactured according to OIML R60 standards

Technical data

CAPACITY	kg			EAC	NET WEIGHT OF LOAD CELL (kg)	CODE
30000		•	•	•	-	TBT30000
40000		•	•	•	-	TBT40000
50000		•	•	•	-	TBT50000
60000		•	•	•	-	TBT60000
100000		•	•	•	-	TBT100000
250000		•	•	•	-	TBT250000

ON REQUEST

Certifications

CERTIFICATIONS ON REQUEST

- Calibration report (ACCREDIA LAT traceability)
- ATEX II 1GD (zone 0-1-2-20-21-22)
- IECEx (zone 0-1-2-20-21-22)
- Complies with the Eurasian Custom Union regulations (Russia, Belarus, Kazakhstan)

Options on request



Two redundant strain gauges Wheatstone bridges (350 Ω) with two output cables; for dual safety systems

DIMENSIONS (mm)

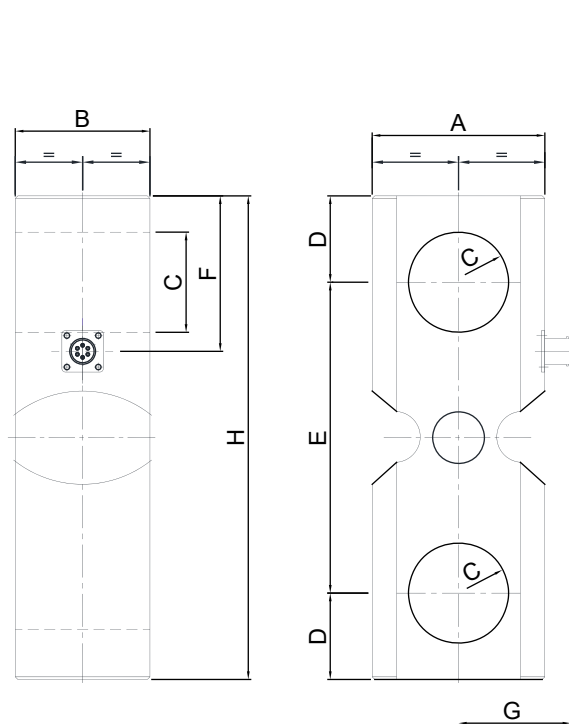

	kg 30000 kg 40000 kg 50000 kg 60000	kg 100000	kg 250000
A	100	127	240
B	78	88	110
C	Ø 58	Ø 71	Ø 102
D	50	70	120
E	180	200	360
F	90	120	185
G	65	68	136
H	280	340	600

Technical features

Material	AISI 420 stainless steel		
Nominal load (E max)	30000 - 40000 - 50000 - 60000 - 100000 - 250000 kg		
Combined error	≤±0.08%		
Protection class	IP68		
Rated output	1.0 mV/V ±0.1%	Input resistance	350 Ω ±20
Temperature effect on zero	0.005% °C	Output resistance	350 Ω ±5
Temperature effect on span	0.005% °C	Zero balance	±1%
Compensated temperature range	-10 °C / +50 °C	Insulation resistance	>5000 MΩ
Operating temperature range	-20 °C / +70 °C	Safe overload (% of full scale)	150%
Creep at nominal load in 30 minutes	0.03%	Ultimate overload (% of full scale)	300%
Max supply voltage without damage	15 V	Deflection at nominal load	0.3 mm

Electrical connections

Cable length	10 m
Cable diameter	6 mm
Cores	4 x 0.25 mm ² / 6 x 0.14 mm ²

